



WASTEWATER DIVISION

DEPARTMENT OF ENVIRONMENTAL MANAGEMENT
108 RAILROAD AVENUE - HILO, HAWAII 96720
(808) 961-8338 - FAX (808) 961-8644

August 24, 2020

DIRECTOR OF HEALTH
STATE DEPARTMENT OF HEALTH
ENVIRONMENTAL MANAGEMENT DIVISION
WASTEWATER BRANCH
2827 Waimano Home Road, #207
Pearl City, HI 96782

Subject: HILO WWTP SEWER SPILL
In-plant Sewage Spill, Hilo, Hawai'i
April 15, 2020: 10:45 AM

This Sewage Spill Report is submitted in accordance with Hawai'i Administrative Rules §11-62, Appendix C, Responses for Wastewater Spill, Overflows, and Discharges ("Spills").

Description of Spill:

1. As indicated in the attached Wastewater Spill Report (see attached APPENDIX E), the operators at Hilo WWTP initially reported 400 gallons of secondary treated effluent from the secondary clarifier scum pit discharged to the ground because the flexible hose disconnected during pumping. Crews were flushing/cleaning the scum pit and discharging it into the septage receiving pit when the hose disconnected. After approximately 4 minutes of pumping, the operator realized that a spill to ground was occurring. Because the spill was reported as 400 gallons, the Superintendent reported the spill to the Wastewater Division (WWD) on Thursday at 4:24 PM.
2. On Friday, April 17, 2020, the WWD Deputy Chief proceeded to gather additional information of the spill event after viewing pictures and a video of the spill event. The additional information gathered included the following:

- WWTP Mechanics first noticed water flowing away from septage receiving pit and traversing along property fence-line (see attached Figure 1); No operators were present so mechanics immediately tracked down and notified operators of the spill; Additional photographs of the spill event (see attached Pictures of Spill).
- A delineation of spill area is shown on a site plan (see attached Figure 1). Based on the plotted measurements, the volume of the spill was calculated to be in the vicinity of 3,403 gallons:

Volume of water around septage receiving station plus road = 1,496 gallons (20' x 40' x 3 inch depth)

Volume of water along Fence = 1,907 gallons (340' x 3' x 3 inch depth)

- Although this represents a standing water volume (ponding), the area (downstream) by the chlorine contact building did not flood. If significantly more spill volume occurred, then this low area would have had an area of ponded water. No one observed any ponding of wastewater in that low lying area.

- The pump that was in service was a Gorman Rupp Trash pump rated at 1,000 gpm with a 6-inch discharge hose.
- Although Superintendent reported a spill duration of 3 minutes, it is unknown how long the spill duration occurred. With no operator present when mechanics discovered spill, it is unknown how long the hose was disconnected.

Corrective Actions Taken:

1. The pump was immediately turned off when it was realized that a spill to ground was occurring.
2. The affected area was cleaned and disinfected with sodium hypochlorite.
3. The spill response team will be re-trained to determine the extent of the spill's impact area and to verify the extent of the spill (in this case, it was not verified that the spill did not migrate beyond the property fence or enter into receiving waters).

Comments/Notes:

The Department of Health was not notified of the spill immediately because the volume of spill was initially reported at 400 gallons. The Superintendent notified the WWD Chief and Deputy Chief on Thursday April 16, 2020 at 4:24 PM that a spill occurred at Hilo WWTP (via email). Information gathering began on Friday, April 17, 2020. An email was received from DOH on Tuesday, April 21, 2020 regarding an unreported sewage spill at Hilo (WWTP). A subsequent telephone message was received from DOH on Wednesday, April 22, 2020 regarding a reported spill quantity of 10,000 gallons at the Hilo WWTP.

Should you have any questions on the above; please contact me at 808-961-8513 (dora.beck@hawaiicounty.gov) or you may contact Eric Takamura, Deputy Division Chief at 808-961-8333 (eric.takamura@hawaiicounty.gov).

I certify under penalty of law that this document and all attachments were prepared under my direction or supervision in accordance with a system designed to assure that qualified personnel properly gather and evaluate the information submitted. Based on my inquiry of the person or persons who manage the system, or those persons directly responsible for gathering the information, the information submitted is, to the best of my knowledge and belief, true, accurate, and complete. I am aware that there are significant penalties for submitting false information, including the possibility of fine and imprisonment for knowing violations.



Dora Beck, P.E.
Wastewater Division Chief

ATTACHMENTS:
Appendix E – Spill Report
Figure 1 – Spill Area
Pictures of Spill (4)

HILO WWTP SEWER SPILL
In-plant Sewage Spill, Hilo, Hawai'i
April 15, 2020: 10:45 AM

Copy: William Kucharski, Director
Eric Takamura, P.E., Wastewater Deputy Division Chief
Raymond Kemp, East Hawai'i Superintendent
Sina Pruder, P.E., DOH-WWB Chief
Sue S. Liu, DOH-WWB Construction and Operations Section

Appendix E
Wastewater Spill and Treatment Plant Bypass or Upset Discharge Report

Location: Hilo WWTP Date: 4/15/2020
NPDES Permit No. (for WWTP's with Permits: HI0021377
Reported By: Jason Imamura TA Operations Supervisor Telephone: 808-961-8756 or
808-938-6408
Report Received By: Ray Kemp, Wastewater Superintendent Time Received: 12:30 pm
Responding Personnel: Eugene Calnan, Operator, IV and Jason Imamura
Time Arrived on Scene: 10:48 am Weather Conditions: Fair
Spill/Bypass Duration: From 4/15/2020, 10:45 am To 4/15/2020 10:48 am
(Date/Time) (Date/Time)

Estimated Volume (Gallons) Discharged: 400

Ground >50, < 1000
gallons
internal to
plant site

State Waters
Dry Well
Other

Description/Cause: Secondary Scum pit was being pumped out with portable pump. Discharge hose was placed down into septage receiving pit. During pumping, hose worked its way out of pit. And released ~400 gal of secondary scum pit water onto ground where it traveled down asphalt inside plant grounds.

Actions Taken: Portable pump was shut off and area was contained, cleaned and disinfected. Draw down of secondary scum pit, as well as liquid trail were measured to determine volume of discharge.

Comments:

Operations was instructed to secure discharge hose by tying it down to further secure it in the future.
This spill was logged into the Non- Public >50 gal. log on our server

Report Completed by (Supervisor with signature/date):

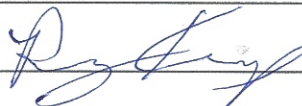

4-22-2020

Sketch of Scene Below (use back of sheet if required)

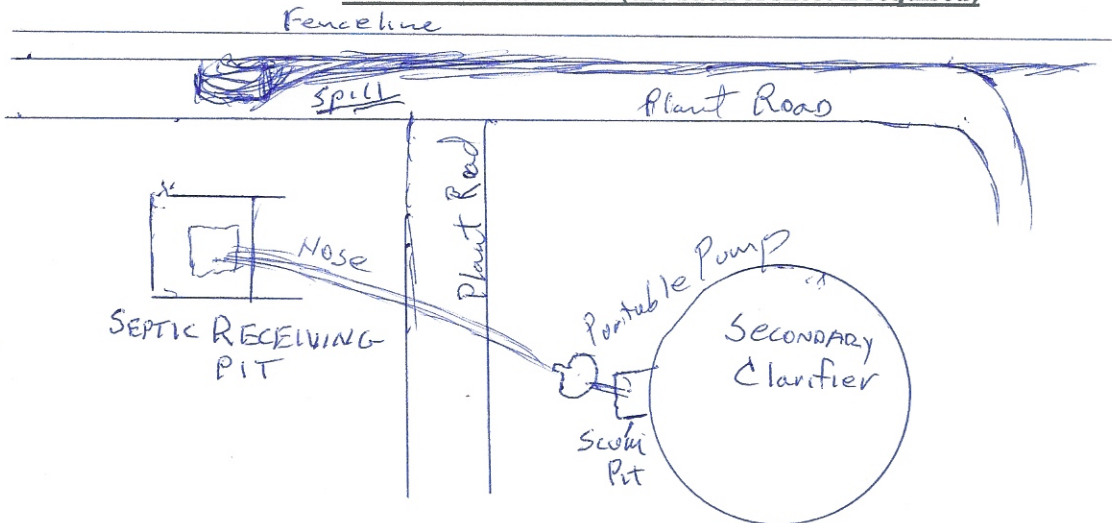
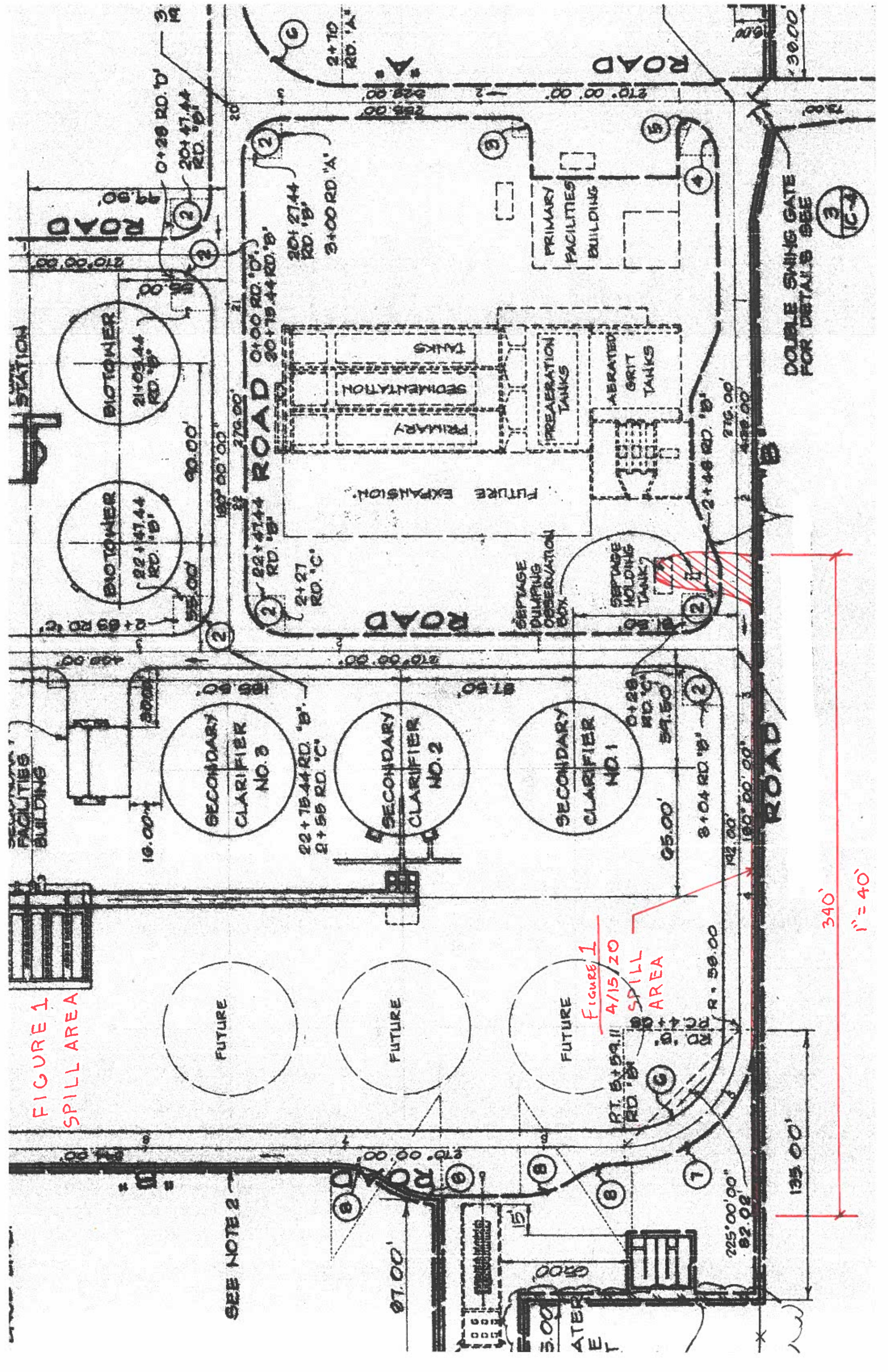

FIGURE 1
SPILL AREA



340'
1" = 40'



